

GFRP / GFRC / GFRG FABRICATIONS



1602 Mizell Road,
Tuskegee AL 36083

Why use FIBLAST Cornice Systems?

- Light weight, Do not require heavy support framing
- Durable: Lifetime product
- Minimal maintenance
- Low co-efficient of thermal expansion
- Low thermal inertia
- Many times stronger than comparable materials
- Corrosion resistant
- Easy installation, saves time
- Large selection of standard shapes available OR Bring your design, we will match it at no extra cost
- Class A, fire retardant per ASTM E-84 panels available
- Tech. Breakthrough: High impact resistant / Blast resistant / bullet resistant panels available

Most FIBLAST Cornice Products contribute towards USGBC LEED-NC v2.2 credits

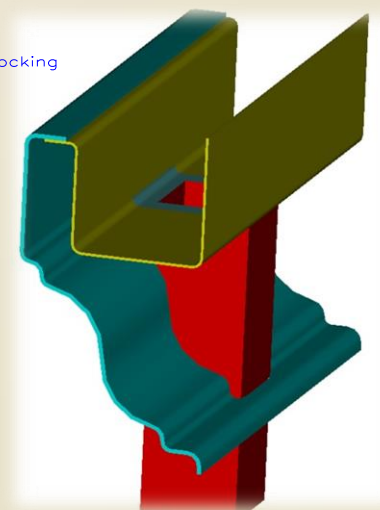
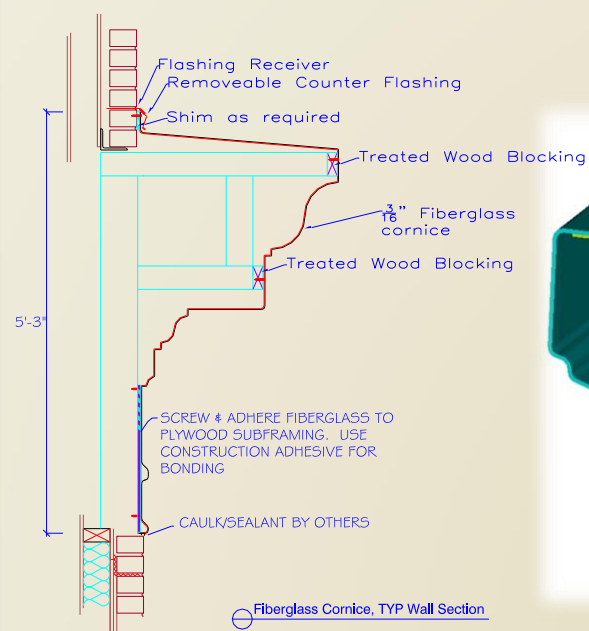
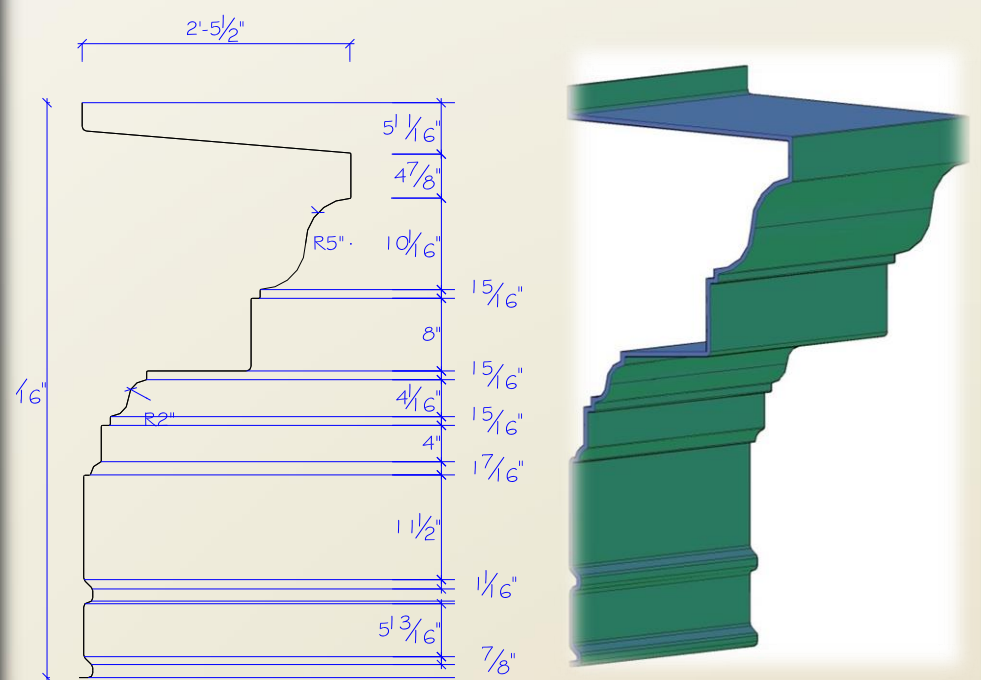
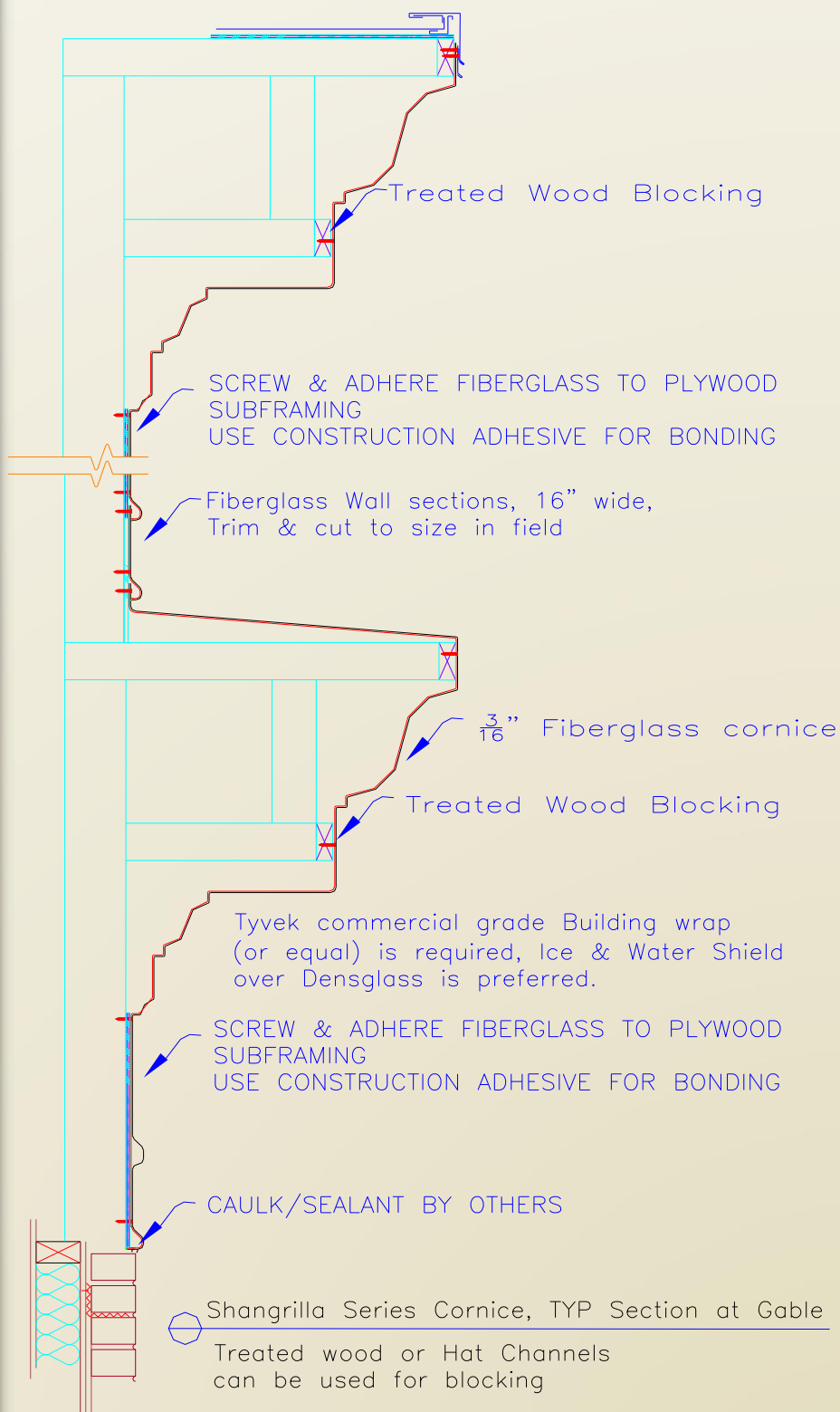

CUSTOM
SHAPES

CUSTOM
SIZES

Tel: 334-315-1314 Fax: 334-239-4333
Sales email:- est1@fiblast.com

FIBLAST, LLC.
www.fiblast.com